

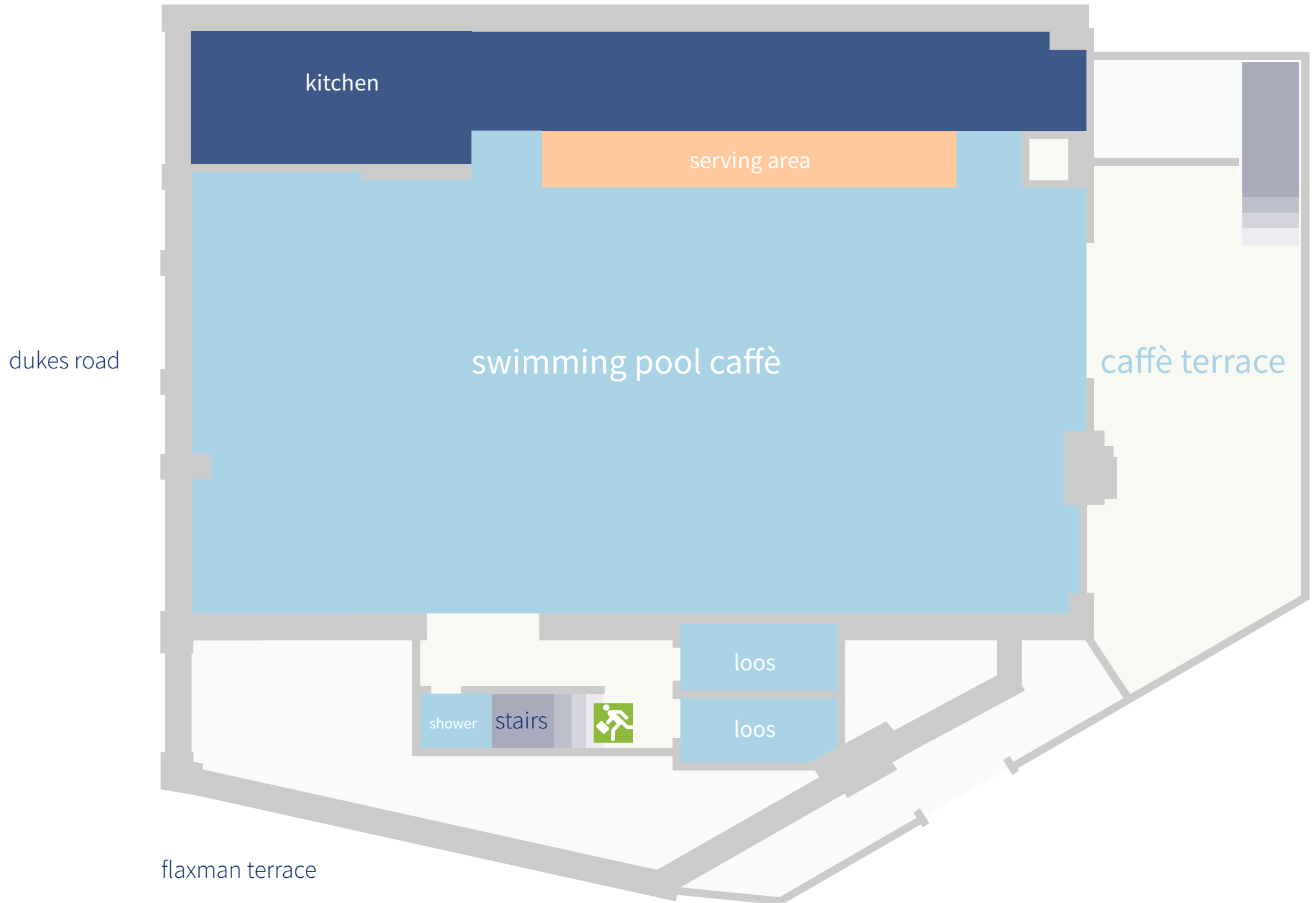

# wallacespace st pancras dimensions and capacities

	dimensions	minimum numbers	max. theatre style	max. u-shape tables + chairs	max. boardroom	max. u-shape chairs	max. cabaret	max. soft seating	working space in square metres
01 keel room	3.2 x 5.4 mtr	8	12	0	10	10	0	8	17
02 rudder room	4.2 x 5.4 mtr	10	16	0	10	12	12	10	22
03 locker room	4.4 x 6.6 mtr	12	20	14	12	16	16	14	29
rudder & locker	6.6 x 8.6 mtr	22	40	20	14	20	30	20	40
11 long room	12.2 x 5.3 mtr	25	70	24	24	40	40	30	65
12 square one	6.0 x 4.85 mtr	10	20	12	14	16	10	12	29
13 glass room	4.8 x 4.1 mtr	6	12	0	8	8	0	8	20
21 corner room	3.8 x 6.3 mtr	8	20	0	12	12	0	8	24
22 clipper room	10.1 x 9.1 mtr	40	110	28	22	40	65	35	92
23 square two	5.6 x 5.2 mtr	10	20	12	14	16	10	12	29
24 dogleg	5.0 x 3.0 mtr	8	16	0	10	12	0	6	15
31 nest one	7.0 x 5.7 mtr	12	40	16	18	20	24	16	45.6
32 nest two	7.0 x 5.7 mtr	12	34	16	18	20	24	16	40
kitchen	18.4 x 9.5 mtr	maximum numbers for dining 100 maximum numbers for a stand up reception 150 maximum numbers for theatre style 150							





wallacespace **st pancras** ground floor

