



## wallacespace **covent garden** dimensions and capacities

	dimensions	minimum numbers	max. theatre style	max. u-shape tables + chairs	max. boardroom	max. u-shape chairs	max. cabaret	max. soft seating	working space in square metres
60ps astoria	8.2 x 5.3 mtr	n/a	n/a	n/a	n/a	n/a	16	n/a	43.5
60ps scala	7.7 x 8.5 mtr	n/a	n/a	n/a	n/a	n/a	25	n/a	65.5
60ps blitz	8.2 x 6.9 mtr	n/a	n/a	n/a	n/a	n/a	n/a	20	56.5
60ps roundhouse	8.2 x 6.4 mtr	n/a	n/a	n/a	n/a	n/a	25	n/a	52.5
60ps marquee	8.2 x 6.7 mtr	n/a	n/a	n/a	n/a	n/a	25	n/a	54.5
the kitchen	13.12 x 3 mtr	maximum numbers for dining 40 maximum numbers for a stand up reception 60 maximum numbers for a theatre style 60							





wallacespace covent garden 60 parker street all floors

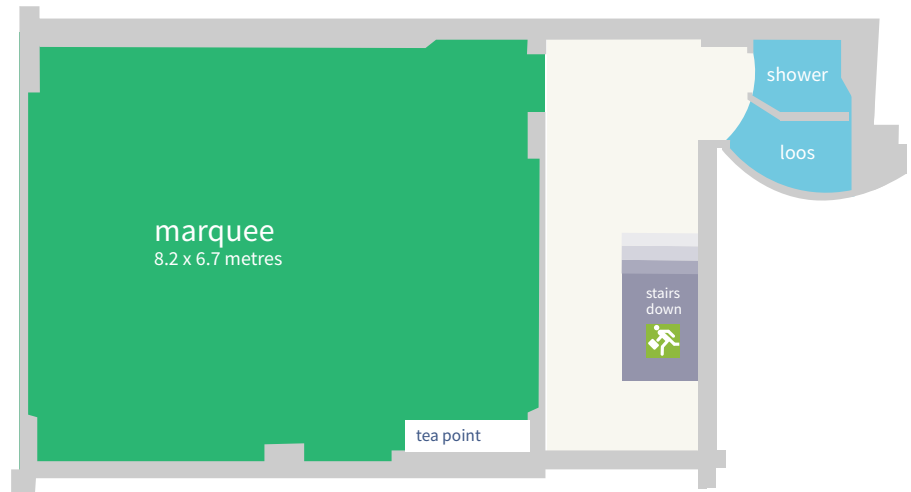
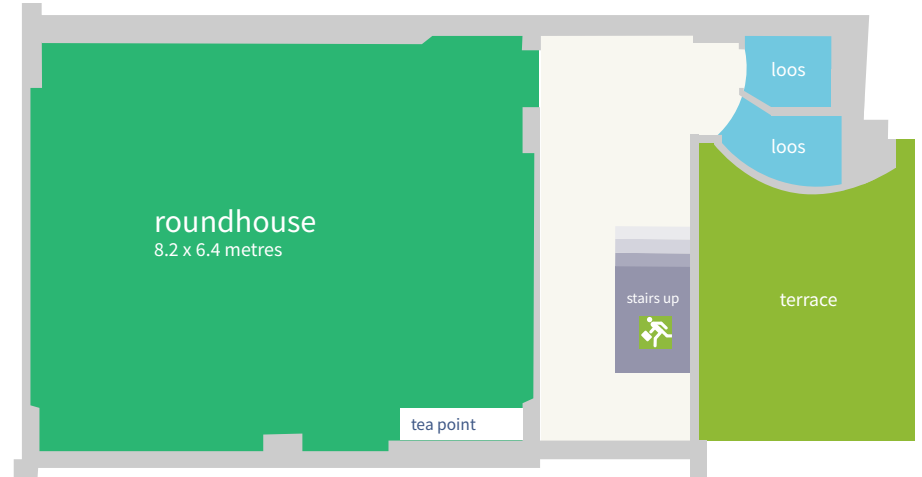
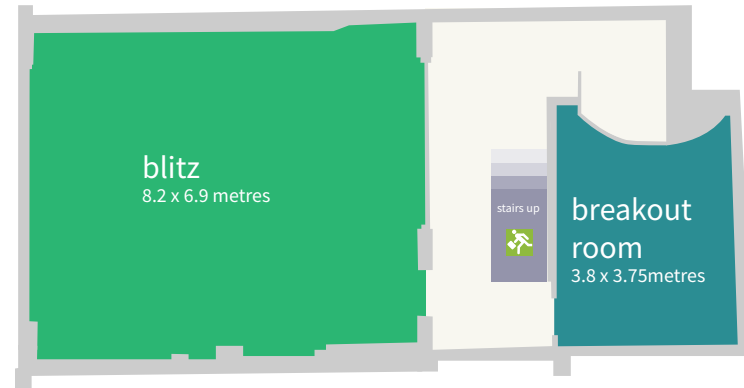
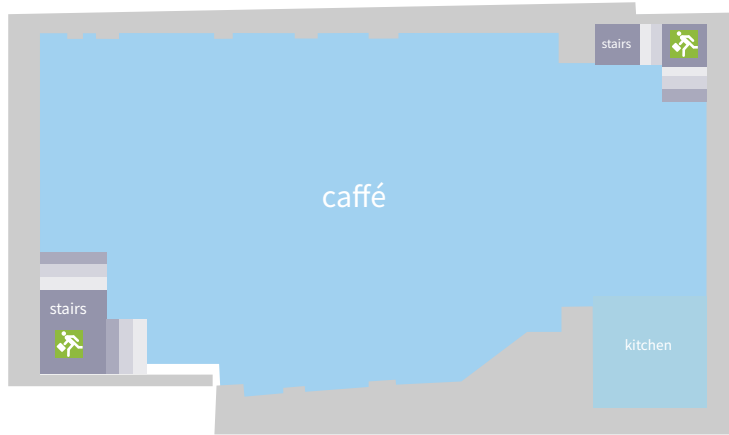



wallacespace **covent garden** 53 parker street first floor



