



# wallacespace clerkenwell green dimensions and capacities

	dimensions	max. theatre style	max. u-shape tables + chairs	max. boardroom	max. u-shape chairs	max. cabaret	max. soft seating	working space in square metres
11 salt room	5.0 x 7.5 mtr	12	8	8	8	9	8	32
12 pepper room	5.0 x 7.5 mtr	10	8	6	8	9	8	32
salt + pepper	10 x 7.5 mtr	16	16	16	16	16	16	63.5
13 sugar room	4.4 x 2.5 mtr	2	2	2	3	0	3	14
14 ginger room	11 x 5.5 mtr	16	11	10	16	12	16	60.5
21 tea room	5.0 x 7.5mtr	12	8	8	8	9	8	32
22 coffee room	5.0 x 7.5 mtr	10	8	6	8	9	8	32
tea + coffee	10 x 7.5 mtr	16	16	16	16	16	16	63.5
13 copper room	4.4 x 2.5 mtr	4	3	3	4	3	4	17
14 tin room	5.4 x 3.3 mtr	10	8	6	8	9	8	34.5
31 silk room	5.1 x 7.5mtr	12	8	8	8	9	8	32
32 cotton room	5.1 x 7.5 mtr	10	8	6	8	9	8	32
silk + cotton	10.1 x 7.5 mtr	18	16	16	16	16	18	63.5
33 flax room	4.5 x 2.5 mtr	2	0	2	2	0	4	15
34 jute room	5.5 x 3.3 mtr	3	0	3	4	0	4	17
35 hemp room	5.5 x 3.3 mtr	3	0	3	3	0	4	17
penthouse a	10.0 x 7.0 mtr	n/a	n/a	n/a	n/a	16	n/a	65
penthouse b	12.5 x 4.0 mtr	15	10	10	15	12	15	48
the den	22 x 6 x 2.4 mtr	35	40	20	30	35	30	185

the kitchen

maximum numbers for dining 35  
 maximum numbers for a stand up reception 170

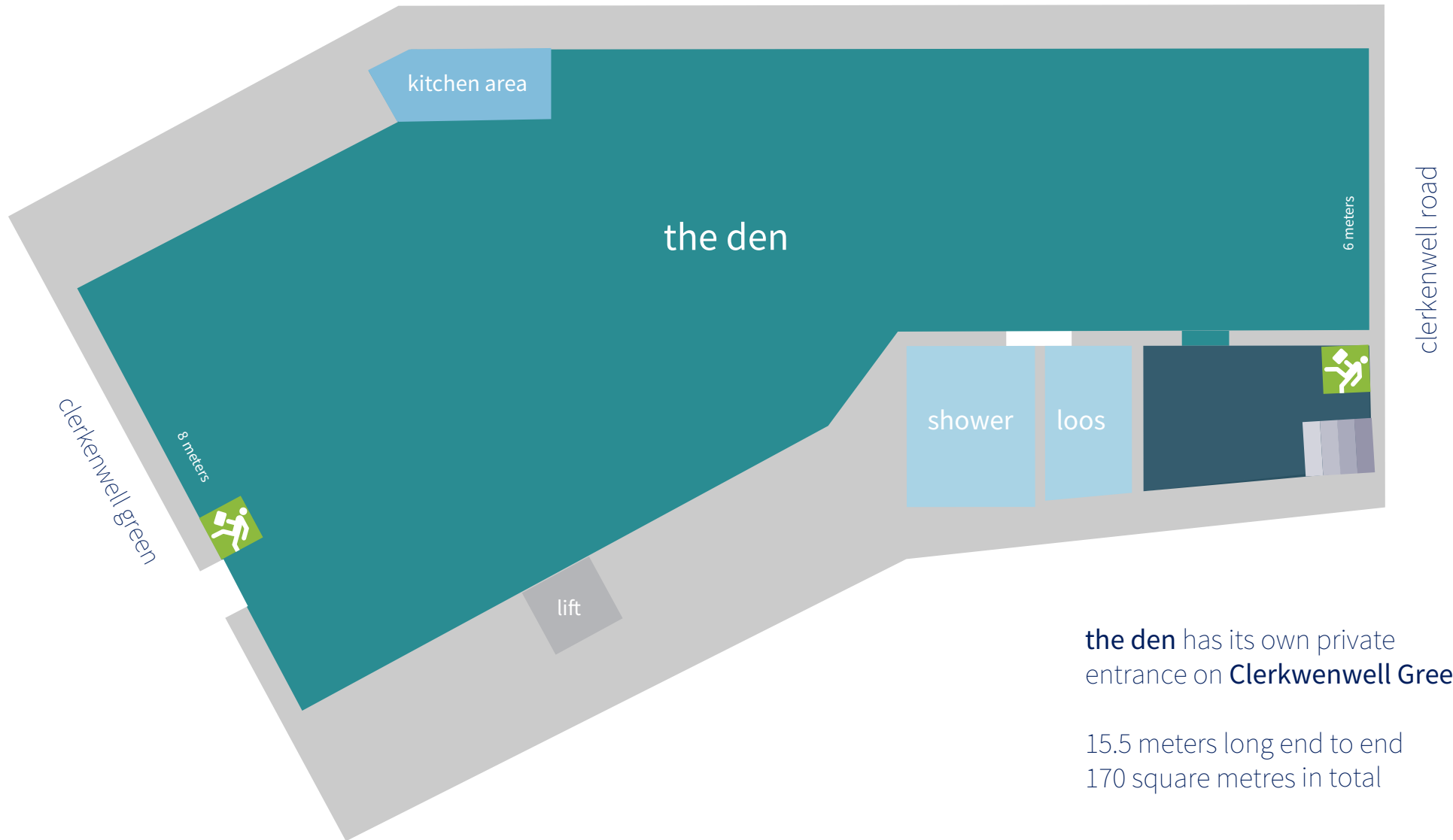

**the den** has its own private entrance on **Clerkwenwell Green**.

15.5 meters long end to end  
170 square metres in total

